

1184 Series

1.27 x 1.27 mm SMT Female Header Dual Row Dual Entry

General specifications

Insulator material	LCP, UL94V-0, color: black
Contact material	Copper alloy
Current rating	1 A
Contact resistance	20 mΩ max.
Insulator resistance	1000 MΩ min.
Dielectrical withstanding	500 VAC for 1 min
Operating temperature	-40 °C to +105 °C
Soldering	JEDEC lead free reflow soldering process
Mating parts series	
1120, 1126, 1170, 1175, 1176, 1104, 1112, 1114, 1152, 1153, 1157, 1158, 1162, 1163	

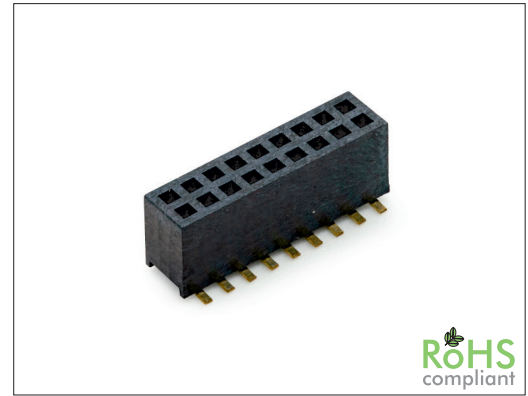

Mechanical dimensions

Unit: mm

w/o position pegs

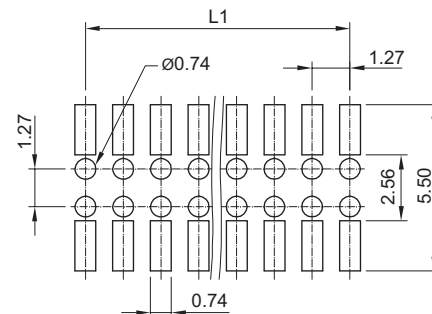
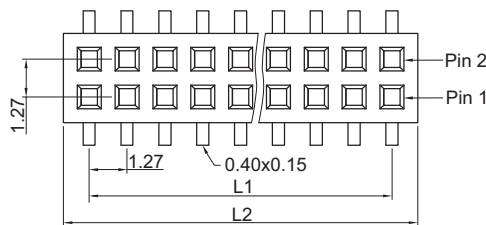

Recommended P.C.B. layout

Height: H=4.65

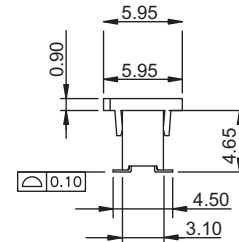
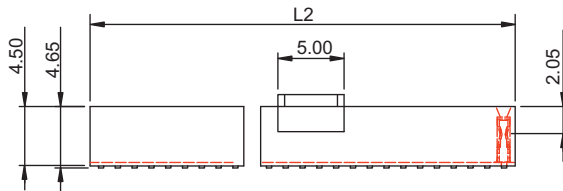

Height: H=3.60

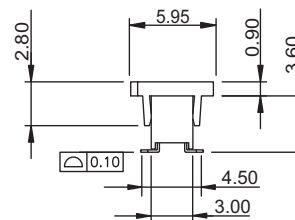
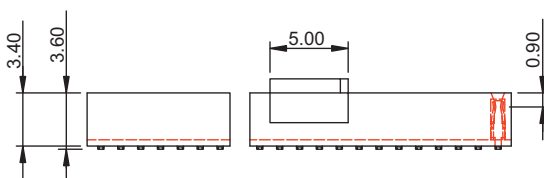

$$L1 = \left(\frac{\text{No. of contacts}}{2} - 1 \right) \times 1.27$$

$$L2 = \left(\frac{\text{No. of contacts}}{2} \right) \times 1.27 + 0.40$$

Tolerances	
Linear	X ± 0.38
	.XX ± 0.25

continued on page 2

Part numbering guide

1184 V	04	B	0	R	
Series V = SMT vertical	No. of contacts 04 to 100	Contact plating B = Flashgold E = 10 μ" gold F = 15 μ" gold J = 30 μ" gold	Height H and position peg 0 = 3.60 mm w/o pos. peg 1 = 3.60 mm w/ pos. peg 2 = 4.65 mm w/o pos. peg 3 = 4.65 mm w/ pos. peg	Packing R = Reel T = Tube	Pick and place option M = Mylar Foil (leave blank for plastic cap)

* standard



Mechanical dimensions

Unit: mm

w/ position pegs, height = 4.65

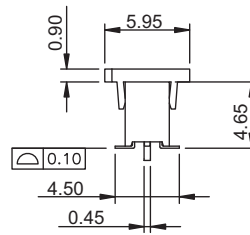
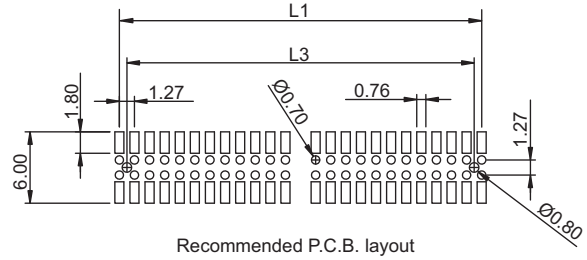
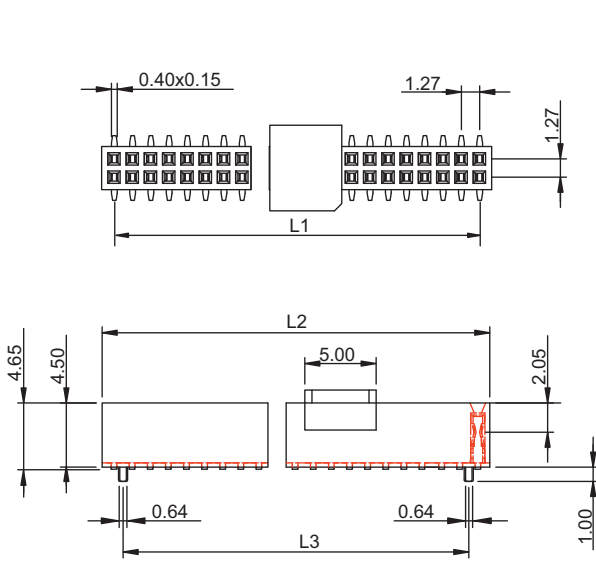

w/ position pegs, height = 3.60

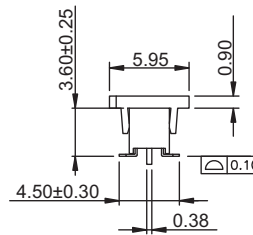
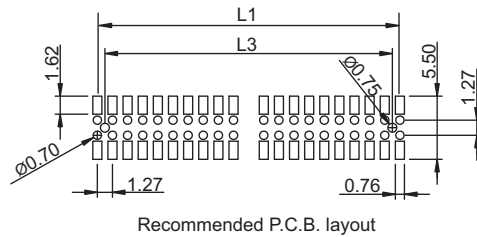
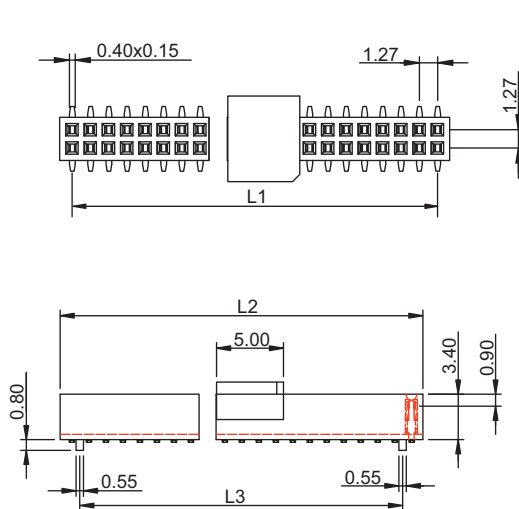

$$L1 = \left(\frac{\text{No. of contacts}}{2} - 1 \right) \times 1.27$$

$$L2 = \left(\frac{\text{No. of contacts}}{2} \right) \times 1.27 + 0.40$$

$$L3 = \left(\frac{\text{No. of contacts}}{2} \right) \times 1.27 - 2.54$$

Tolerances		
Linear	X	± 0.38
	.XX	± 0.25

