

1004 Series

1.00 x 1.00 mm SMT Box Header Dual Row

General specifications

Insulator material	LCP, UL94V-0, color: black
Contact material	Phosphor bronze
Current rating	1 A
Contact resistance	20 mΩ max.
Insulator resistance	1000 MΩ min.
Dielectrical withstanding	300 VAC for 1 min
Operating temperature	-40 °C to +125 °C
Soldering	JEDEC leadfree reflow soldering process

Mating parts series

1008

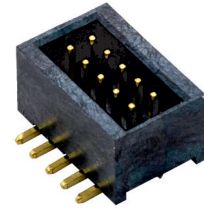

Mechanical dimensions

Unit: mm

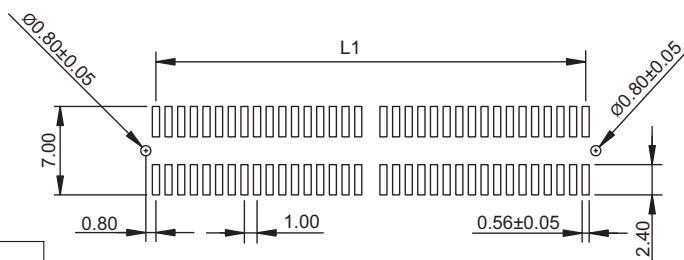
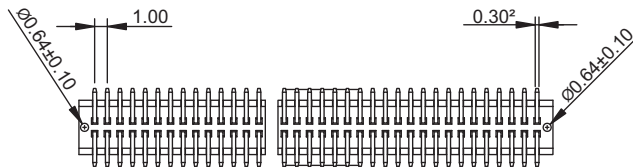
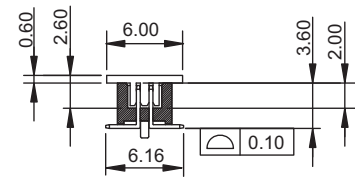
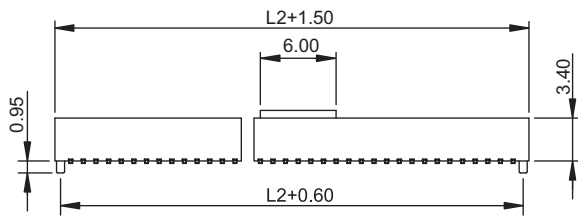
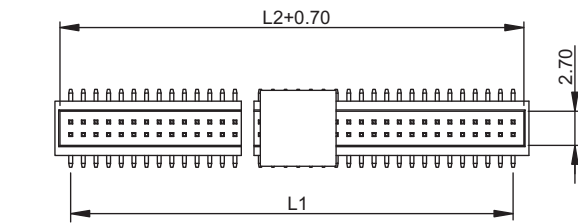

Recommended P.C.B. layout

Tolerances		
Linear	X	± 0.30
	.XX	± 0.20
	.XXX	± 0.10

Part numbering guide

1004 V	06	E	1	R
Series V = SMT vertical	No. of contacts 06 to 100	Plating B = Flashgold E = 10 μ" gold F = 15 μ" gold J = 30 μ" gold	Position peg 0 = w/o position peg 1 = w/ position peg*	Packing with pick & place pad R = Reel

* standard

