

Specifications	
Contact rating	0.4 VA max. @ 20 V AC or DC
Durability	30000 cycles at full load
Contact resistance	20 mΩ max. initial @ 3 VDC, 100 mA
Insulator resistance	1000 MΩ min.
Dielectrical withstanding	1500 VAC
Degree of protection	IP67
Operation temperature	-30 °C to +85 °C
Materials	
Case and bushing	Glass filled nylon 4/6, UL94V-0
Actuator	Copper alloy, plating: chrome
Contact and terminal	Copper alloy, plating: see order code and table
Switch support	Copper alloy, plating: tin
Terminal seal	Epoxy

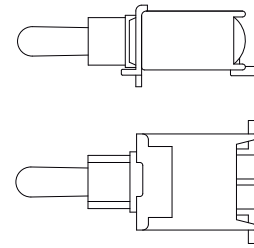

Part numbering guide

S **W** - **E** **S** - **3** - **T** **2** **N** **R** - **T/R** - **H**

Switches Function		Actuator		Terminal		Contact Plating		RoHS Code
ES-3	SP on-none-on	T1	10.16	(none)	std	Q	silver (std.)	H = RoHS Compliant
ES-3B	SP on-none-(on)	T2	Std. 6.10	N	backward	R	gold	
ES-3A	SP on-off-on	T3	8.13	M	backward	G	gold over silver	
ES-3H	SP (on)-off-(on)	T4	13.97			K	gold / tin	
ES-3I	SP on-off-(on)	T5	3.5					
		ESD Protection Actuator				Package		
		P1	(black) 10.16			(none)	polly bag	
		P11	(white) 10.16			T/R	tape & reel	
		P2	(std - black) 6.10					
		P21	(white) 6.10					

P2, P21: ESD resistant option, actuator insulating: 9000 VDC min. between actuator to terminals
actuator material: Nylon 4/6, black, UL94V-0

Contact material option

Code	Contact material	Terminal material	Rating
Q	Silver plated	Silver plated	3 A @ 120V AC or 28 V DC; 1.5 A @ 250 VAC
R	Gold plated over nickel plated	Gold plated over nickel plated	0.4VA MAX @ 20 V AC or DC MAX
G	Gold plated over silver plated	Gold plated over silver plated	0.4 VA MAX @ 20 V AC or DC MAX or 3 A @ 120V AC or 28 V DC; 1.5 A @ 250 VAC
K	Gold plated over nickel plated	Tin over nickel plated	0.4VA MAX @ 20 V AC or DC MAX

continued on page 2



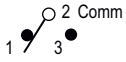

Model No.	Switching position		
ES-3	ON	none	ON
ES-3A	ON	OFF	ON
ES-3B	ON	None	(ON)
ES-3H	(ON)	OFF	(ON)
ES-3I	ON	OFF	(ON)
Term. Comm.	2-3	open	2-1

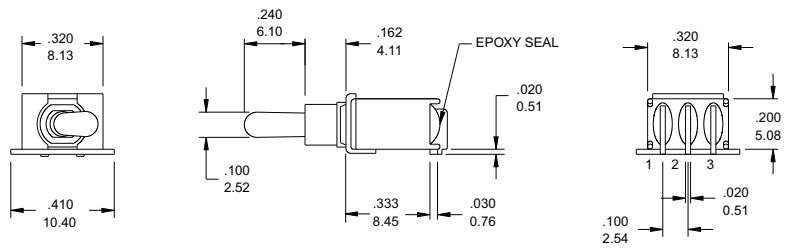

SW-ES-3-T2

Terminal type M, N

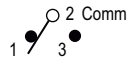
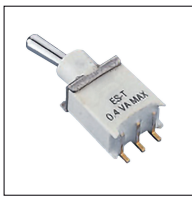

Model No.	Switching position		
ES-3	ON	none	ON
ES-3A	ON	OFF	ON
ES-3B	ON	None	(ON)
ES-3H	(ON)	OFF	(ON)
ES-3I	ON	OFF	(ON)
Term. Comm.	2-3	open	2-1

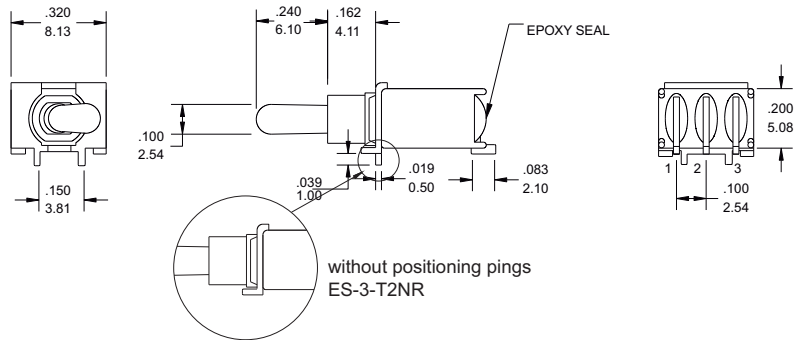

SW-ES-3-T2MR

Actuator Option

T1

T2

T3

T4

T5

Plastic toggle

P1

P2

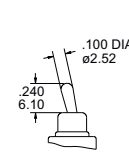
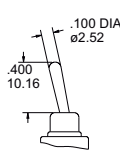
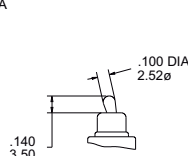
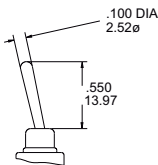
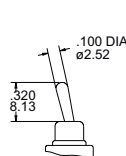
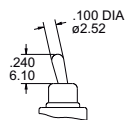
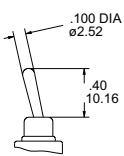

Code	Description
P1/P2	black (std.)
P11/P21	white

Material nylon 4/6 (UL 94V-0), black std.
Static resistance: 9,000V DC min. actuator to terminals

Recommended P.C.B. layout

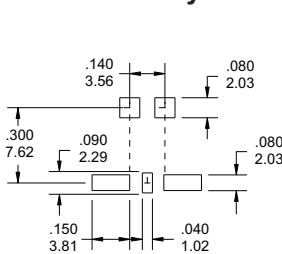

SW-ES-3

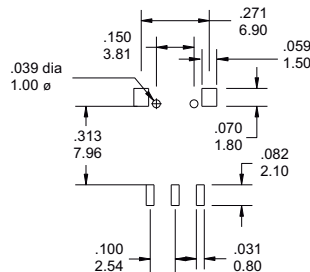

SW-ES-3-M

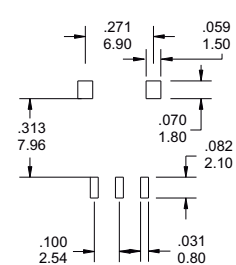

SW-ES-3-N

