

1570 Series

2.54 mm Female Header Dual Row

General specifications

Insulator material	PBT w/ glass fiber, UL94V-0, color: black
Contact material	Copper alloy
Current rating	3 A
Voltage rating	250 VAC
Contact resistance	20 mΩ max.
Insulator resistance	5000 MΩ min.
Dielectrical withstanding	1000 VAC for 1 min
Operating temperature	-40 °C to +105 °C
Soldering	Lead free wave soldering process

Mating parts series

1520, 1525, 1534, 1620, 1622, 1634

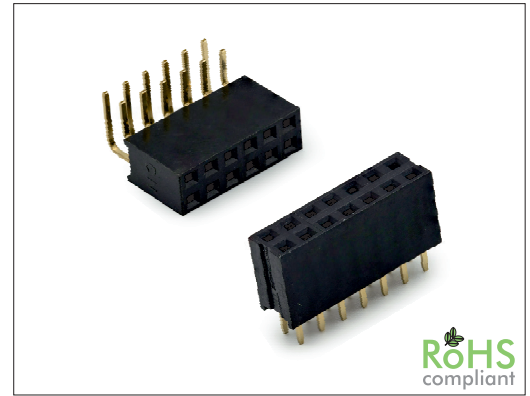

Mechanical dimensions

Unit: mm

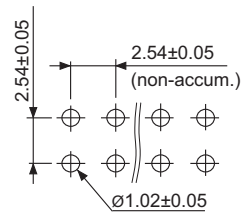
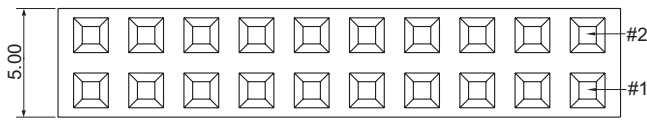

Recommended P.C.B. layout

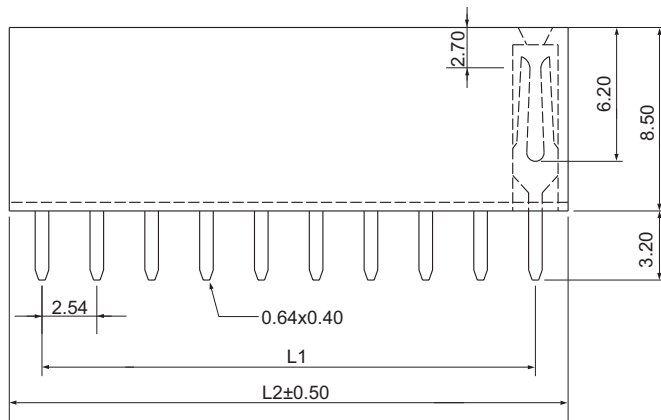

$$L1 = \left(\frac{\text{No. of contacts}}{2} - 1 \right) \times 2.54$$

$$L2 = \left(\frac{\text{No. of contacts}}{2} \right) \times 2.54 + 0.50$$

1570S

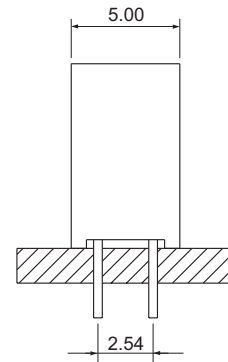

1570R

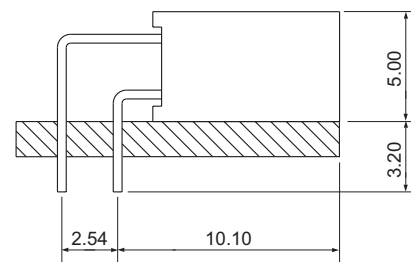

Tolerances	
Linear	.X ± 0.38
	.XX ± 0.25

continued on page 2

Part numbering guide

1570 S — **04** — **B**

Series
S = THT straight
R = THT right angle

No. of contacts
04 to 80

Contact plating
B = Flashgold
E = 10 μm gold
F = 15 μm gold
J = 30 μm gold

* standard



1570 Series

2.54 mm Female Header Dual Row Pin in Paste

General specifications

Insulator material	Nylon 6T, UL94V-0, color: black
Contact material	Copper alloy
Current rating	3 A
Voltage rating	250 VAC
Contact resistance	20 mΩ max.
Insulator resistance	5000 MΩ min.
Dielectrical withstanding	1000 VAC for 1 min
Operating temperature	-40 °C to +105 °C
Soldering	JEDEC lead free reflow soldering process

Mating parts series

1520, 1525, 1534, 1620, 1622, 1634

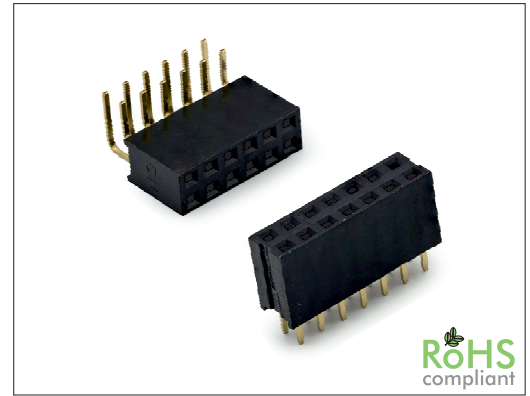

Mechanical dimensions

Unit: mm

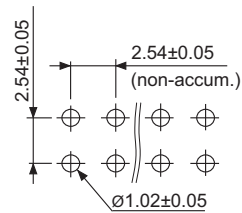
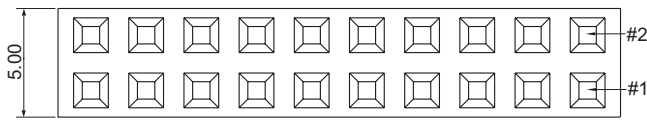

Recommended P.C.B. layout

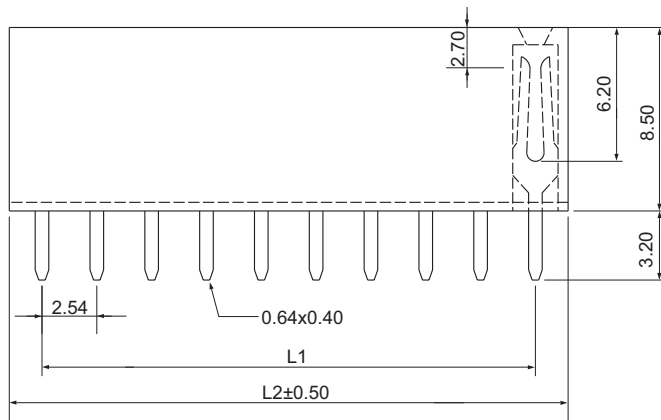

$$L1 = \left(\frac{\text{No. of contacts}}{2} - 1 \right) \times 2.54$$

$$L2 = \left(\frac{\text{No. of contacts}}{2} \right) \times 2.54 + 0.50$$

1570S

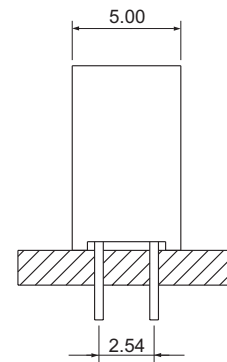

1570R

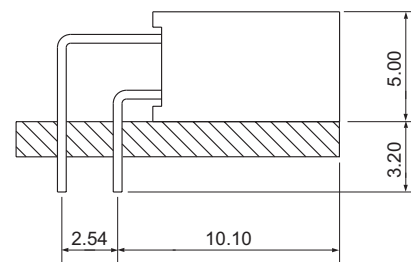

Tolerances		
Linear	.X	± 0.38
	.XX	± 0.25

Part numbering guide

1570 S	04	B	R
Series S = THR straight R = THR right angle	No. of contacts 04 to 80	Contact plating B = Flashgold E = 10 μm gold F = 15 μm gold J = 30 μm gold	Packing R = Reel

* standard

