

# 3107 Series

# D-Sub C8W8 Housing

## General specifications

Insulator material	Glass filled polyester, UL94V-0
Contact material	Brass
Shell material	Steel, plating: tin
Insulator resistance	5000 MΩ min.
Dielectrical withstanding	1000 VAC for 1 min
Operating temperature	-55 °C to +125 °C
Durability	100 cycles
<b>Mating parts series</b>	



## Mechanical dimensions

Unit: mm

### 3107M

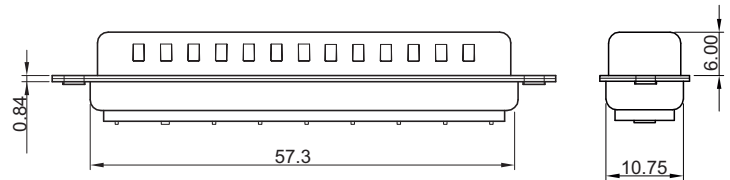
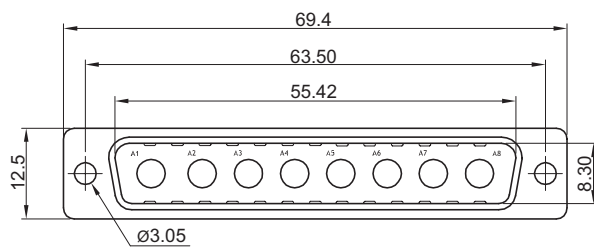

### 3107F

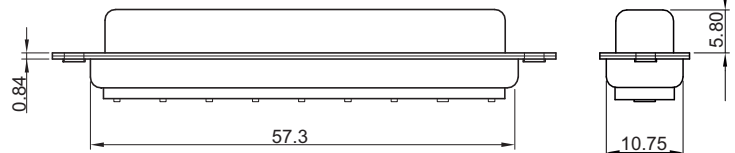
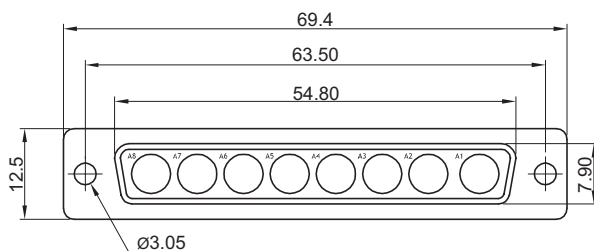

Applicable contact series	
High power	3117, 3118
Coaxial	3119

Tolerances		
Linear	X	± 0.30
	XX	± 0.20
	XXX	± 0.10

Type 0 (w/ ø3.05 holes)	Type A (w/ rivited front bolts)	Type B (w/ rivited front bolts)	Type C (w/ rivited rear bolts)

## Part numbering guide



\* standard

