

# SW-DHA Series SMT DIP Switch 1.27 mm

## General specifications

Housing material	Nylon, UL94V-0, color: black
Actuator material	LCP, UL94V-0, color: white
Contact material	Copper alloy, plating: gold
Current rating	25 mA (switching), 100 mA (non-switching)
Voltage rating	24 VDC (switching), 50 VDC (non-switching)
Contact resistance	100 mΩ max.
Insulator resistance	100 MΩ min. @ 100 VDC
Dielectrical withstanding	300 VAC for 1 min
Operating temperature	-40 °C to +85 °C
Operating force	500 gf max.
Durability	1000 cycles
Soldering	JEDEC lead free reflow soldering process

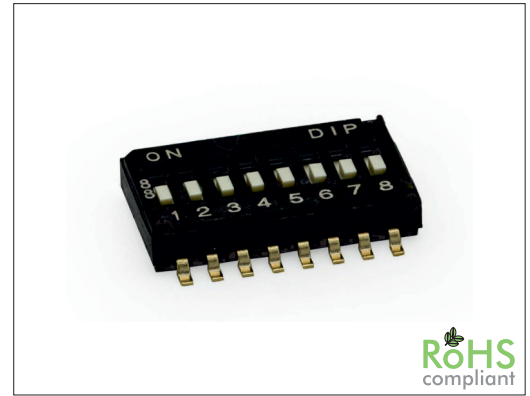

RoHS  
compliant

## Mechanical dimensions

Unit: mm

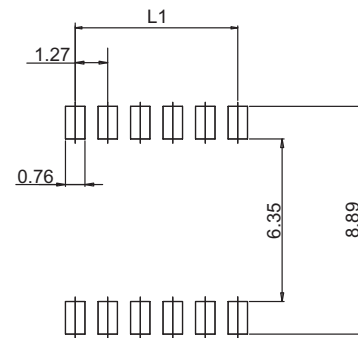
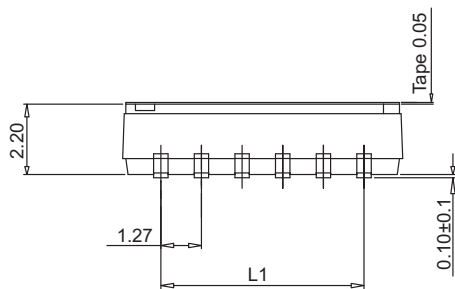
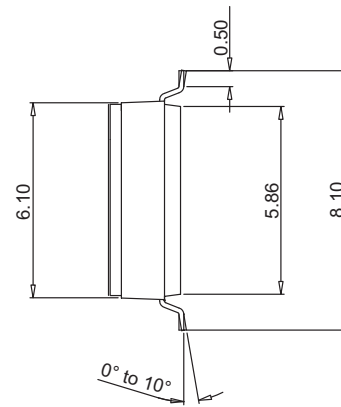
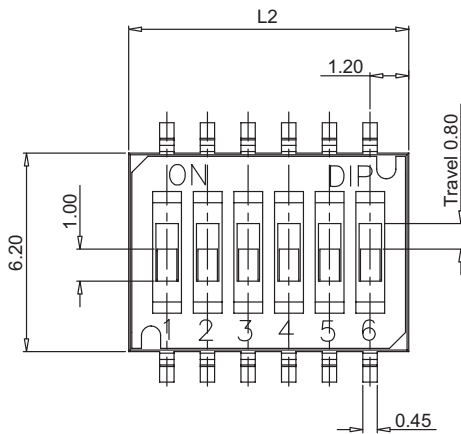

Recommended P.C.B. layout

L1 = No. of positions x 1.27 - 1.27  
L2 = No. of positions x 1.27 + 1.13

Tolerances	
Linear	± 0.20

## Part numbering guide

SW-DHA	02		T	Q	R
Series	No. of positions 02, 04, 06, 08, 10, 12	Optional position N = „ON“ position (leave blank for „OFF“ position)	Optional tape sealed T = Top tape sealed* (leave blank for not tape sealed)	Material Q = Halogen free	Packing R = Reel* (leave blank for tube)

\* standard

