

2119 Series

1.25 mm Housing and Terminal

General specifications

| | |
|----------------------------|---------------------------------|
| Insulator material | Nylon 66, UL94V-0, color: black |
| Contact material | Phosphor bronze |
| Current rating | 1 A |
| Voltage rating | 200 V AC/DC |
| Contact resistance | 40 mΩ max. |
| Insulator resistance | 100 MΩ min. |
| Dielectrical withstanding | 500 VAC for 1 min |
| Operating temperature | -25 °C to +85 °C |
| Mating parts series | |
| 2119-H | |



RoHS
compliant

Mechanical dimensions

Unit: mm

2119P

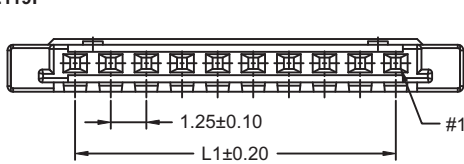

L1 = No. of contacts x 1.25 - 1.25
L2 = No. of contacts x 1.25 + 1.30
L3 = No. of contacts x 1.25 + 3.50

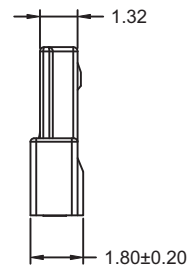
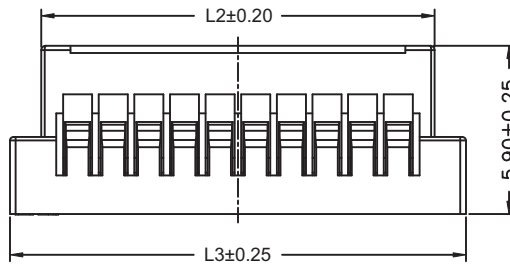

2119T

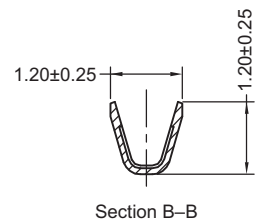
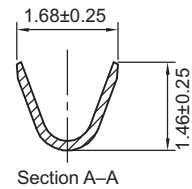
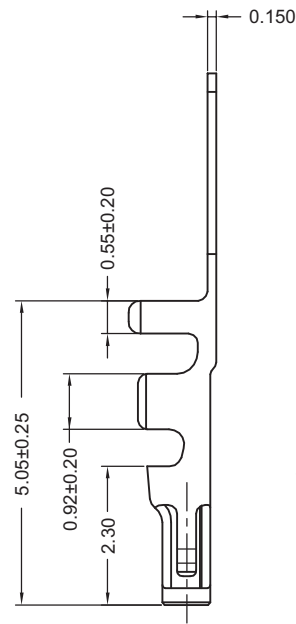
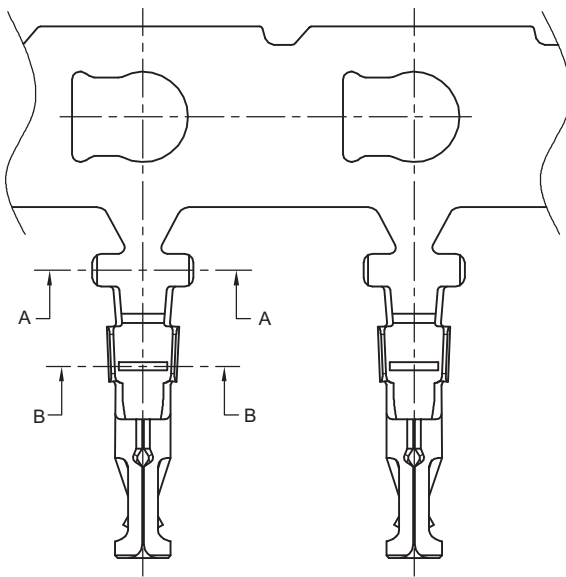

Wire range: AWG 28 to 32

| Tolerances | | |
|------------|------|--------|
| Linear | X | ± 0.25 |
| | .XX | ± 0.15 |
| | .XXX | ± 0.05 |

Part numbering guide

2119 P

02

T

Series
P = Housing
T = Terminal

No. of contacts
02 to 15, 20, 25, 30
(leave blank for terminal)

Contact plating
T = Tin
B = Flashgold
(leave blank for housing)

* standard

