

General specifications

Insulator material	LCP, UL94V-0, color: black
Contact material	Phosphor bronze
Current rating	0.5 A
Voltage rating	35 VAC
Contact resistance	50 mΩ max.
Insulator resistance	1000 MΩ min.
Dielectrical withstanding	500 VAC for 1 min
Operating temperature	-40 °C to +80 °C
Soldering	JEDEC lead free reflow soldering process
Durability	50 cycles

Mating parts series



Mechanical dimensions

Unit: mm

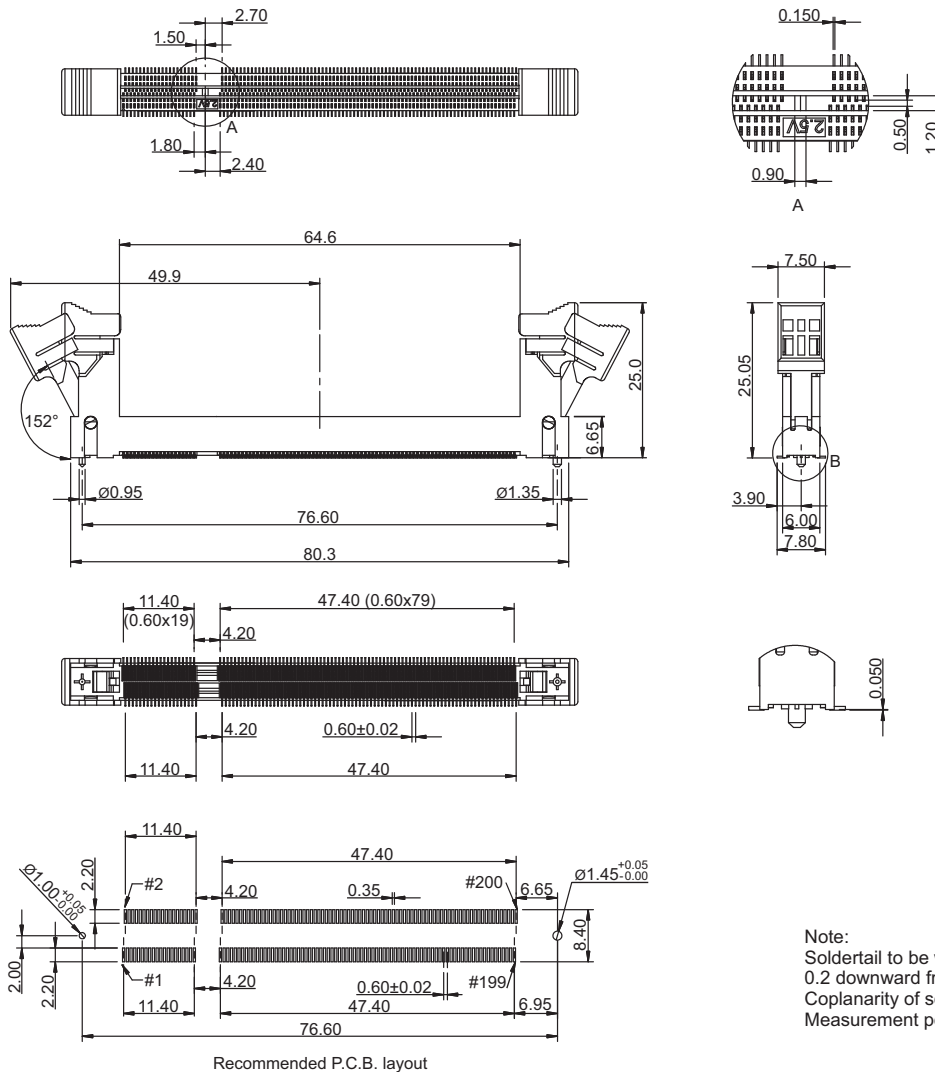

Recommended P.C.B. layout

Note:
Soldertail to be within 0.05 upward and 0.2 downward from Z-datum place.
Coplanarity of soldertails to be within 0.10.
Measurement point is soldertails tip.

continued on page 2

Tolerances		
Linear	X.	± 0.30
	X	± 0.20
	.XX	± 0.10
	.XXX	± 0.05

Part numbering guide

5216 V — **B**

Series V = SMT vertical Contact plating B = Flashgold

* standard



Mechanical dimensions

Unit: mm

Recommended dimensions for insertion card:

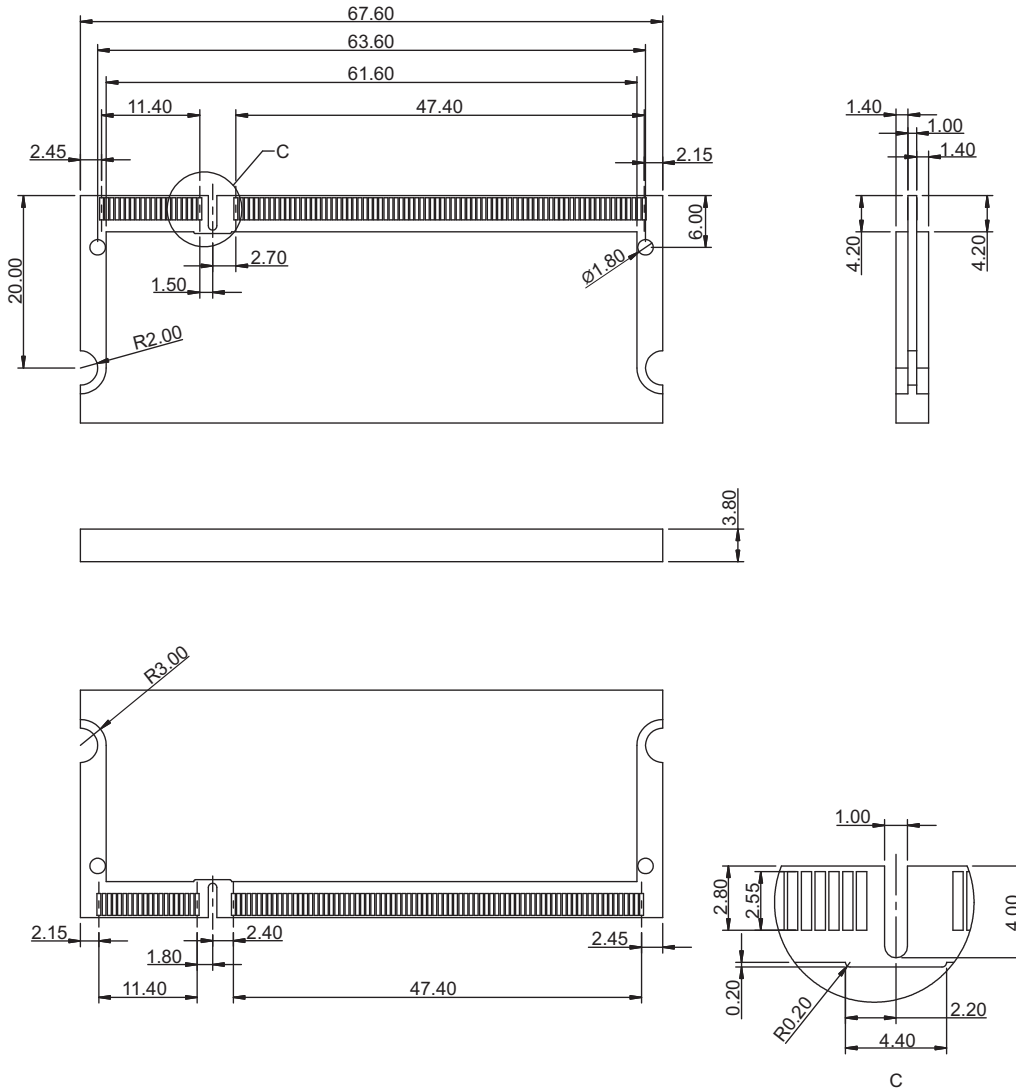

Tolerances		
Linear	X.	± 0.30
	.X	± 0.20
	.XX	± 0.10
	.XXX	± 0.05

