

2301 Series

3.00 mm Micro MF SMT Header Straight Single Row

General specifications

Insulator material	Nylon 6T or Nylon 9T, UL94V-0, color: black
Contact material	Copper alloy
Current rating	5 A (with two pins 7 A max.)
Voltage rating	250 V AC/DC
Contact resistance	10 mΩ max.
Insulator resistance	1000 MΩ min.
Dielectrical withstanding	1500 VAC for 1 min
Operating temperature	-40 °C to +105 °C
Soldering	JEDEC lead free reflow soldering process

Mating parts series

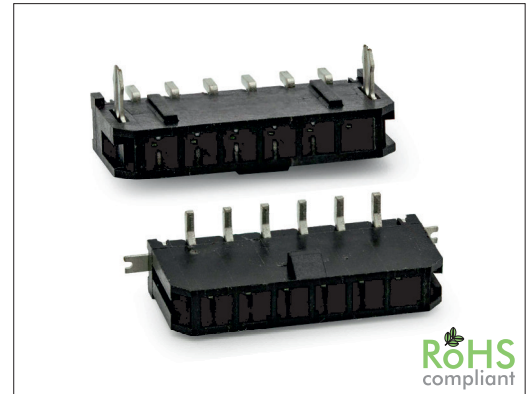

Mechanical dimensions

Unit: mm

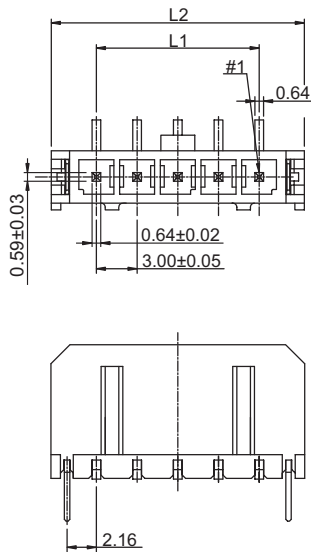

2301V w/ metal board lock

$$L1 = (\text{No. of contacts} - 1) \times 3.00$$

$$L2 = \text{No. of contacts} \times 3.00 + 3.65$$

$$L3 = L1 + 4.30$$

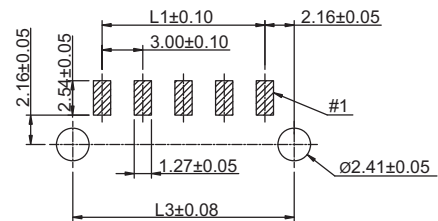
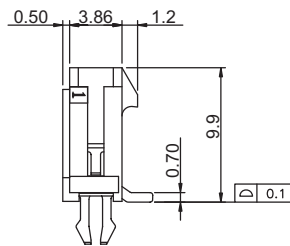

Recommended P.C.B. layout

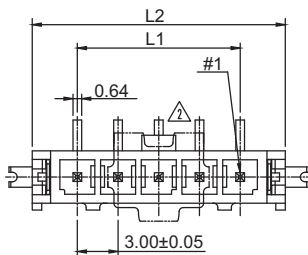

2301V w/ fixed tabs

$$L1 = (\text{No. of contacts} - 1) \times 3.00$$

$$L2 = \text{No. of contacts} \times 3.00 + 3.65$$

$$L3 = L1 + 11.20$$

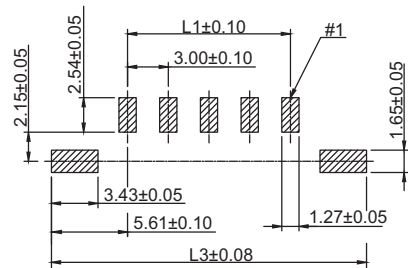
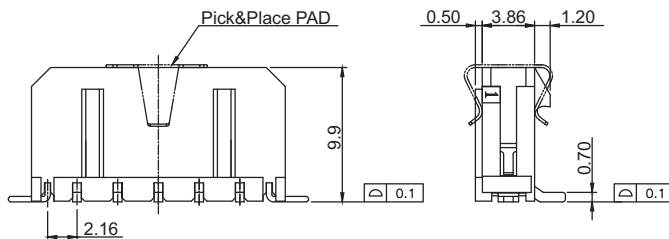

Recommended P.C.B. layout

Tolerances	
Linear	X ± 0.38
	.XX ± 0.25

continued on page 2

Part numbering guide

2301 V	02	B	0	R
Series V = SMT vertical H = SMT horizontal	No. of contacts 02 to 12	Contact plating B = Flashgold F = 15 μ" gold T = Tin	Mounting option 0 = w/ metal board lock 1 = w/ fixed tabs 2 = w/ plastic board lock (only for 2301H)	Packing R = Reel (only for 2301V w/ fixed tabs) T = Tube

* standard



Mechanical dimensions

Unit: mm

2301H w/ metal board lock

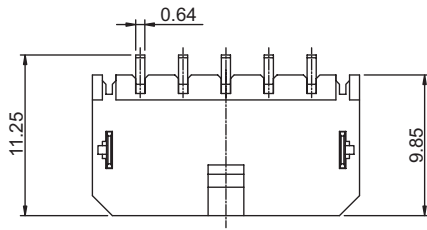

$$L1 = (\text{No. of contacts} - 1) \times 3.00$$

$$L2 = \text{No. of contacts} \times 3.00 + 3.65$$

$$L3 = L1 + 4.30$$

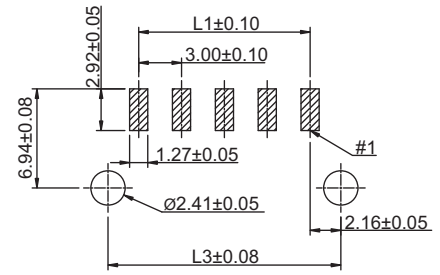
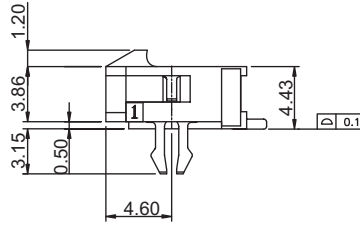
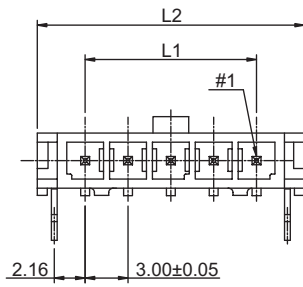

Recommended P.C.B. layout

2301H w/ fixed tabs

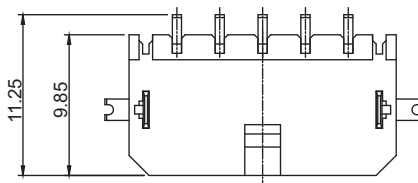

$$L1 = (\text{No. of contacts} - 1) \times 3.00$$

$$L2 = \text{No. of contacts} \times 3.00 + 3.65$$

$$L3 = L1 + 11.20$$

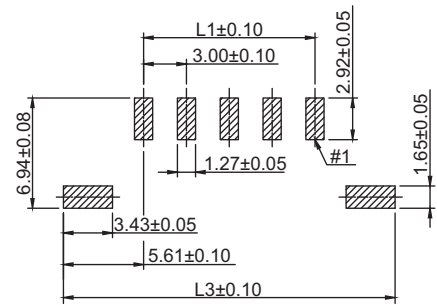
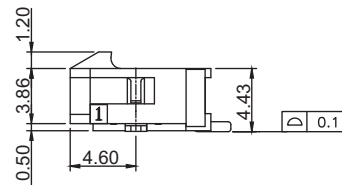
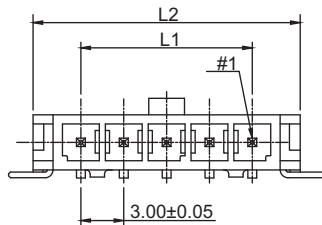

Recommended P.C.B. layout

2301H w/ plastic board lock

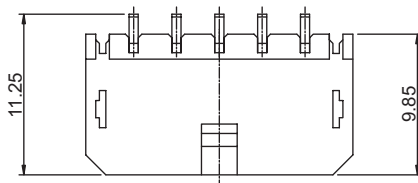

$$L1 = (\text{No. of contacts} - 1) \times 3.00$$

$$L2 = \text{No. of contacts} \times 3.00 + 3.65$$

$$L3 = L1 - 4.30$$

(for 4 to 12 contacts)

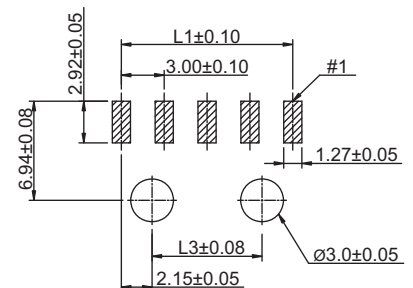
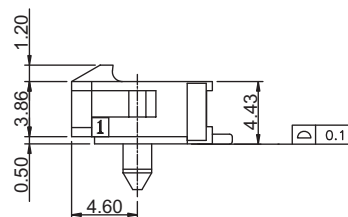
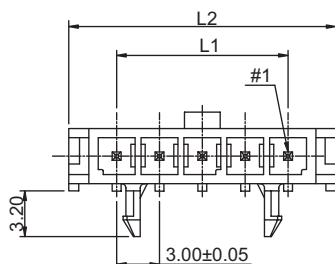

4 to 12 contacts



2 contacts

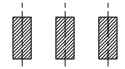

3 contacts

Recommended P.C.B. layouts

Tolerances		
Linear	.X	± 0.38
	.XX	± 0.25

