

2500 Series

5.00 mm Housing w/ Lock and Terminal

General specifications

Insulator material	Nylon 66, UL94V-0, color: nature
Contact material	Phosphor bronze, plating: tin
Current rating	7 A
Voltage rating	250 V AC/DC
Contact resistance	20 mΩ max.
Insulator resistance	1000 MΩ min.
Dielectrical withstanding	1500 VAC for 1 min
Operating temperature	-25 °C to +85 °C
Wire range	AWG 18 to 22

Mating parts series

2500-SR

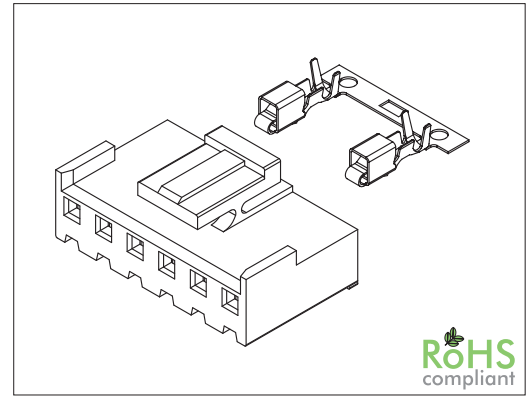

RoHS
compliant

Mechanical dimensions

Unit: mm

2500P

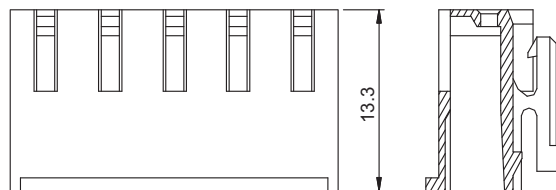
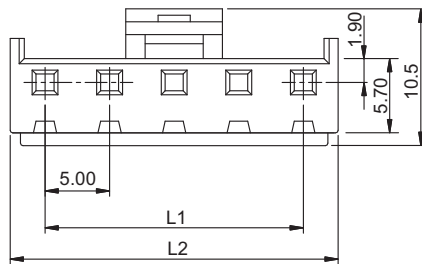

$$L1 = (\text{No. of contacts} - 1) \times 5.00$$

$$L2 = \text{No. of contacts} \times 5.00$$

2500T

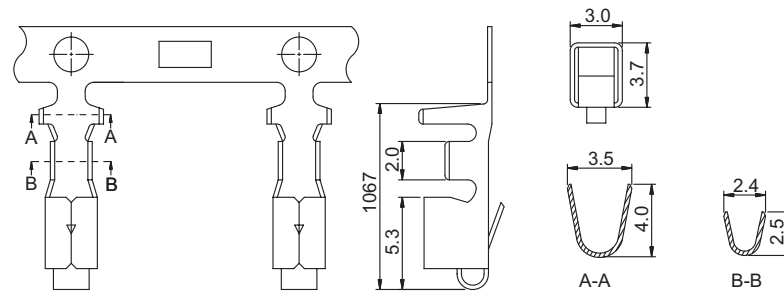

Tolerances		
Linear	.X	± 0.38
	.XX	± 0.25

Part numbering guide

2500 P

Series
P = Housing
T = Terminal

B

Terminal material
B = Brass
P = Phosphor bronze
leave blank for terminal

02

No. of contacts
02 to 12
leave blank for terminal

* standard

