

1186 Series

1.27 x 1.27 mm SMT Female Header Dual Row w/ Pos. Peg

General specifications

Insulator material	LCP, UL94V-0
Contact material	Phosphor bronze
Current rating	1 A
Contact resistance	20 mΩ max.
Insulator resistance	5000 MΩ min.
Dielectrical withstanding	500 VAC for 1 min
Operating temperature	-40 °C to +125 °C
Soldering	JEDEC lead free reflow soldering process

Mating parts series

1120, 1126, 1170, 1176

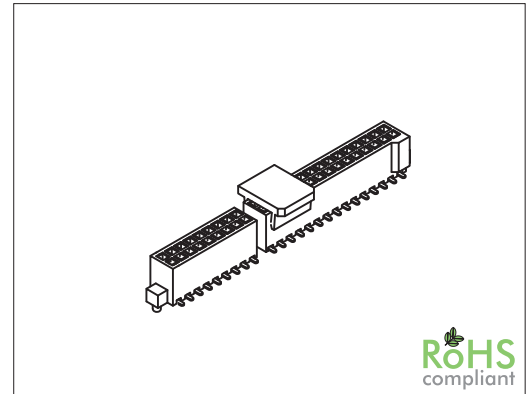

Mechanical dimensions

Unit: mm

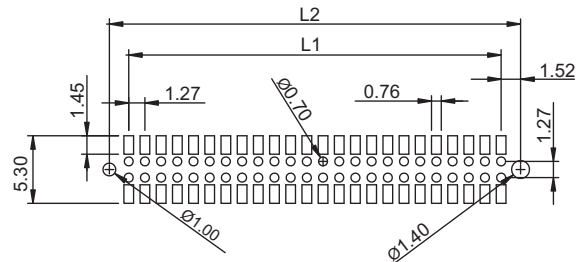
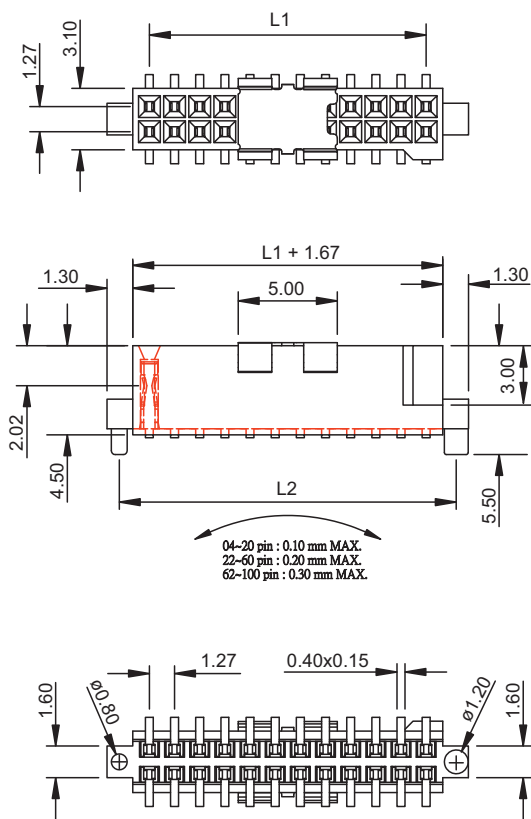

Recommended P.C.B. layout

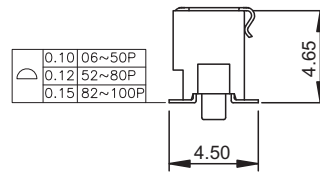

$$L1 = \left(\frac{\text{No. of contacts}}{2} - 1 \right) \times 1.27$$

$$L2 = \left(\frac{\text{No. of contacts}}{2} - 1 \right) \times 1.27 + 3.04$$

Tolerances	
Linear	.X ± 0.38
	.XX ± 0.25

Part numbering guide

1186 V	04	B	R
Series V = SMT vertical	No. of contacts 04 to 100	Contact plating B = Flashgold F = 15 μ" gold D = 5 μ" gold J = 30 μ" gold E = 10 μ" gold	Packing with pick & place pad R = Reel T = Tube

* standard

