

2101 Series

1.00 mm Housing and Terminal

General specifications

Insulator material	Polyester, UL94V-0, color: white
Contact material	Phosphor bronze, plating: tin
Current rating	1 A
Voltage rating	50 V AC/DC
Contact resistance	20 mΩ max.
Insulator resistance	100 MΩ min.
Dielectrical withstanding	500 VAC for 1 min
Operating temperature	-25 °C to +85 °C
Mating parts series	
2101-HV	



Mechanical dimensions

Unit: mm

2101P

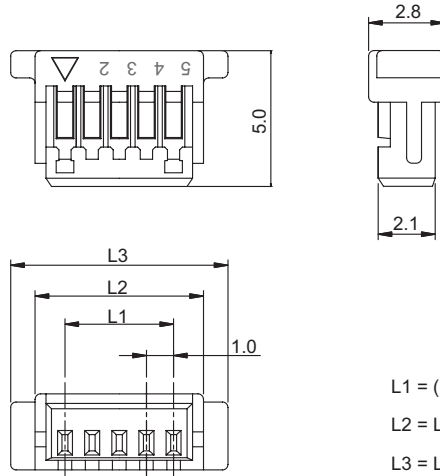

$$L1 = (\text{No. of contacts} - 1) \times 1.00$$

$$L2 = L1 + 2.0$$

$$L3 = L1 + 4.0$$

2101T
Replaceable w/ 2102T

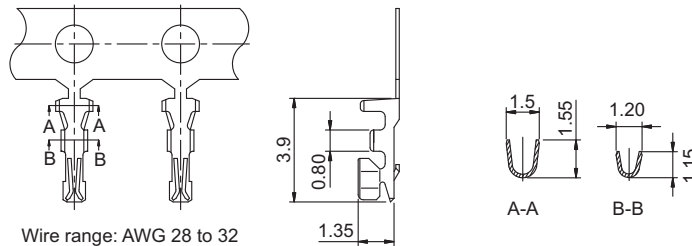

Wire range: AWG 28 to 32

Tolerances		
Linear	X	± 0.30
	.XX	± 0.20
	.XXX	± 0.10

Part numbering guide

2101 P

02

Series
P = Housing
T = Terminal

No. of contacts
02 to 15
(leave blank for terminals)

* standard

