

1235 Series

1.27 x 2.54 mm Female Header

General specifications

Insulator material	Nylon-6T, UL94V-0, color: black
Contact material	Copper alloy
Current rating	1 A
Contact resistance	20 mΩ max.
Insulator resistance	1000 MΩ min.
Dielectrical withstanding	500 VAC for 1 min.
Operating temperature	-40 °C to +105 °C
Soldering	Lead free wave soldering process

Mating parts series

1200, 1211, 1250

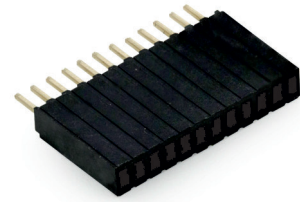

Mechanical dimensions

Unit: mm

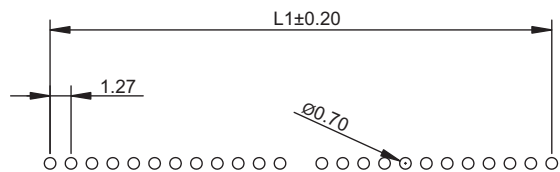
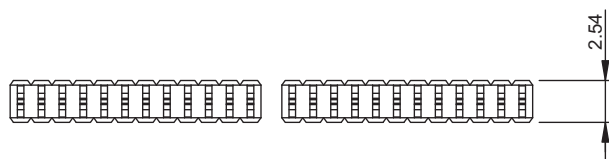
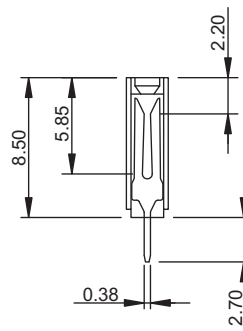
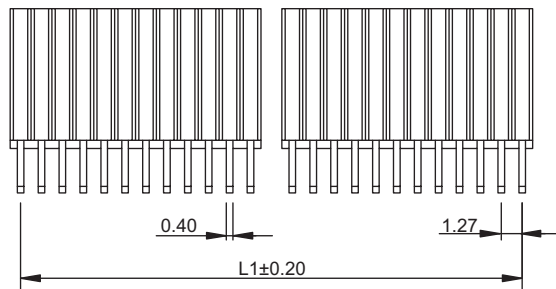
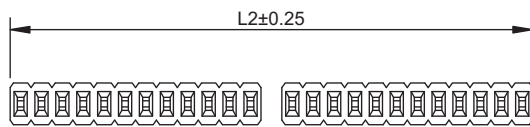

Recommended P.C.B. layout

$$L1 = (\text{No. of contacts} - 1) \times 1.27$$

$$L2 = \text{No. of contacts} \times 1.27$$

Tolerances	
Linear	X ± 0.38
	.XX ± 0.25

Part numbering guide

1235 S — **02** — **B**

Series
S = THT straight

No. of contacts
02 to 50

Contact plating
B = Flashgold
E = 10 μ" gold
F = 15 μ" gold
J = 30 μ" gold

* standard

