

# 2203 Series

# 2.00 mm PHD SMT Pin Header Dual Row

General specifications	
Insulator material	High temperature plastic, UL94V-0, color: natural
Contact material	Brass
Current rating	3 A
Voltage rating	250 V AC/DC
Contact resistance	20 mΩ max.
Insulator resistance	1000 MΩ min.
Dielectrical withstanding	800 VAC for 1 min
Operating temperature	-25 °C to +85 °C
Soldering	JEDEC lead free reflow soldering process
Mating parts series	
2203-PT or cable assembly	

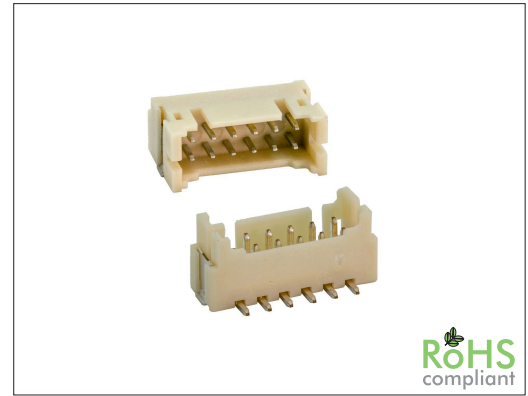

## Mechanical dimensions

Unit: mm

### 2203V

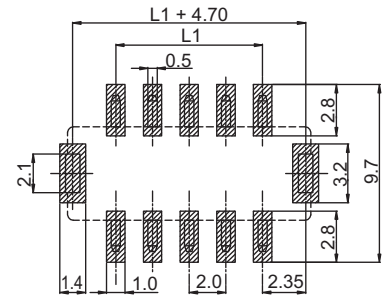
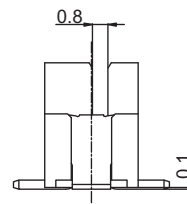
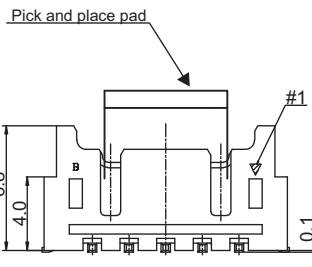
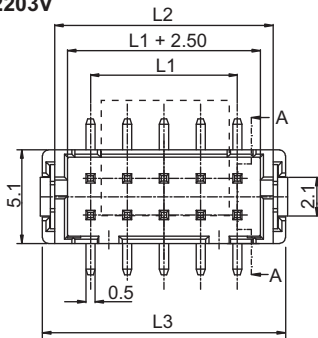

Recommended P.C.B. layout  
Solder side

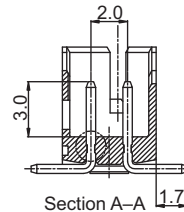

L1 = No. of contacts / 2 x 2.00 - 2.00  
L2 = No. of contacts / 2 x 2.00 + 1.90  
L3 = L1 + 4.80

### 2203H

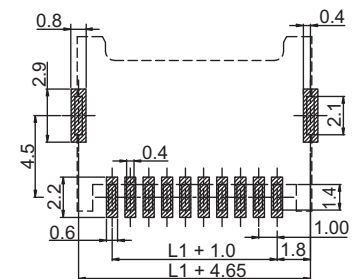
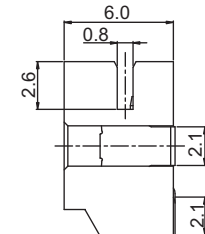
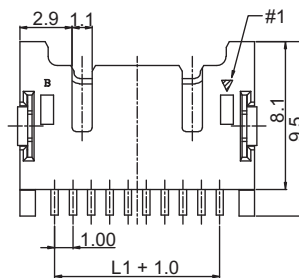
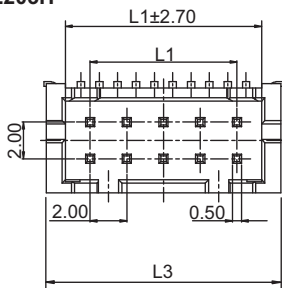

Recommended P.C.B. layout  
Solder side

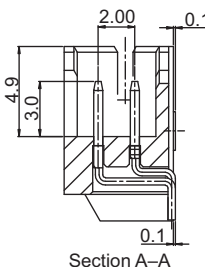

Tolerances		
Linear	X	± 0.25
	.XX	± 0.12
	.XXX	± 0.08

## Part numbering guide

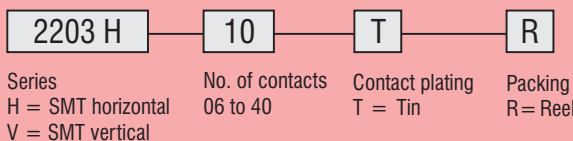

\* standard

