

# 2300 Series

# 3.00 mm Micro MF Male Contact Housing

## General specifications

Insulator material	PBT or Nylon PA66, UL94V-0, color: black
Contact material	Phosphor bronze
Current rating	5 A (with two pins wire AWG20 6.5 A max.)
Voltage rating	250 VAC
Contact resistance	10 mΩ max.
Insulator resistance	1000 MΩ min.
Dielectrical withstanding	1500 VAC for 1 min
Operation temperature	-40 °C to +105 °C
Wire range	AWG 20 to 30

## Mating parts series

2300-P or cable assembly



## Mechanical dimensions

Unit: mm

### 2300M

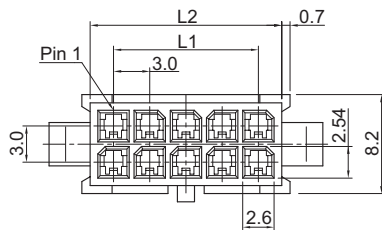

### Back view

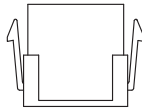

### w/o ears

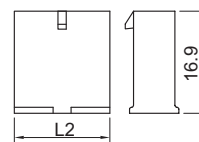

$$L1 = \left( \frac{\text{No. of contacts}}{2} - 1 \right) \times 3.00$$

$$L2 = \left( \frac{\text{No. of contacts}}{2} \right) \times 3.00 + 0.90$$

$$L3 = \left( \frac{\text{No. of contacts}}{2} \right) \times 3.00 + 1.10$$

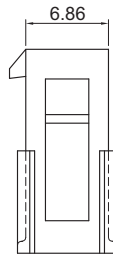
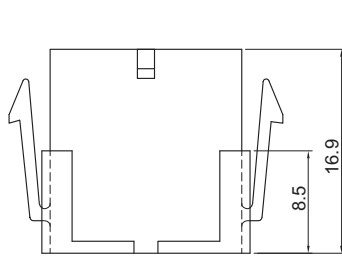

### Example panel cut-out for 8pin

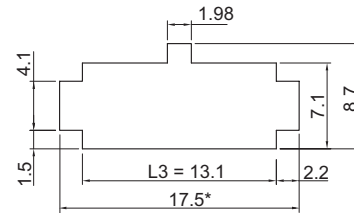

### 2300Z

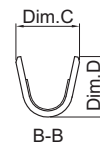
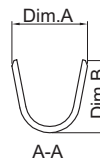
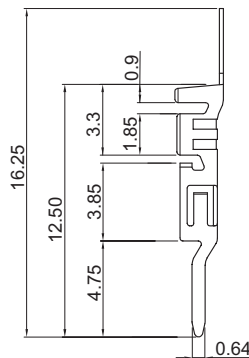
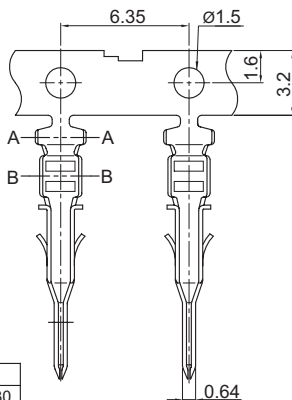

AWG	Dim.A	Dim.B	Dim.C	Dim.D
20 to 24	2.5	2.4	2.1	2.0
26 to 30	2.1	1.9	1.7	1.5

### Tolerances

Linear	X	± 0.30
	.XX	± 0.20
	.XXX	± 0.10

## Part numbering guide

**2300 M**

Series  
M = Housing  
Z = Terminal

**02**

No. of contacts  
02 to 24  
leave blank for terminal

**B**

Contact plating  
B = Flashgold  
F = 15 μ" gold  
T = Tin  
leave blank for housing

**W**

Mounting flanges  
W = w/ flanges  
O = w/o flanges  
leave blank for terminal

Option for 2300Z  
blank = AWG 20 to 24  
2 = AWG 26 to 30

\* standard

